

**South West Coast Path: Man Sands Beach, Kingswear**

Report of the Director of Environment, Economy and Culture

***Please note that the following recommendation is subject to consideration and determination by the Committee before taking effect.***

**Recommendation: It is recommended that no action be taken at this time with regard to the Coast Path at Man Sands Beach, but the matter be kept under review.**

**1. Summary**

Councillor Hawkins has requested that the Committee be advised of the diversion of the Coast Path at Man Sands beach in South Devon following winter storms.

**2. Background**

In the Winter of 2003/04 the National Trust, who own and maintain this section of the Coast Path, removed gabion baskets along a shingle bar at Man Sands beach as they were breaking up and causing a hazard to walkers. Rather than go to the expense of replacing them and in line with NT policy on managed retreat, the shingle bar was left to revert to its natural dynamic state. Following the work a large lake formed in the meadow behind the shingle bar.

During storms in late February/early March 2007 the shingle bar was breached causing a dramatic emptying of the lake. Walkers were advised to use an alternative inland route via Mansands Lane and Woodhuish Lane shown on the accompanying plan ED/PROW/07/78. The diversion involved a lengthy detour of 1.7 miles along steep paths, but the flow of water across the shingle bar has now reduced substantially and it is once again possible to walk the Coast Path on its original line using stepping stones, except at very high spring tides.

Photographs of the Coast Path and the lake prior to the breach are shown overleaf.

**3. Possible Long Term Diversion**

The National Trust has indicated that it does not intend to re-establish the shingle bar as natural processes are likely to result in a similar breach. They will, however, be monitoring the situation to ensure that use of the Coast Path is not unduly restricted when the flow of water onto the beach increases over the Winter months. If the Coast Path does become impassable for long periods it may prove necessary to establish a more permanent alternative route, but it should be possible to create a significantly shorter route to that implemented immediately after the breach.

**4. Reasons for Recommendation**

The situation at Man Sands is not uncommon and diversions of the Coast Path are implemented regularly following erosion and storm damage. Indeed, there are a number of sections of the Coast Path which use high and low tide routes and several river crossings where restricted ferry services operate.

If it should become necessary to establish a permanent alternative route then full consultations will be undertaken with interested bodies.

## 5. Legal Considerations

No direct implications at this time.

Edward Chorlton

### Electoral Division: Dartmouth & Kingswear

Local Government Act 1972

List of Background Papers

Contact for enquiries: Mike Jenkins

Room No:

Tel No: (01392) 383240

Background Paper	Date	File Ref.
None		

mj290607pra  
sn/man sands beach Kingswear  
2 hq 290607



**Coast Path prior to breach**

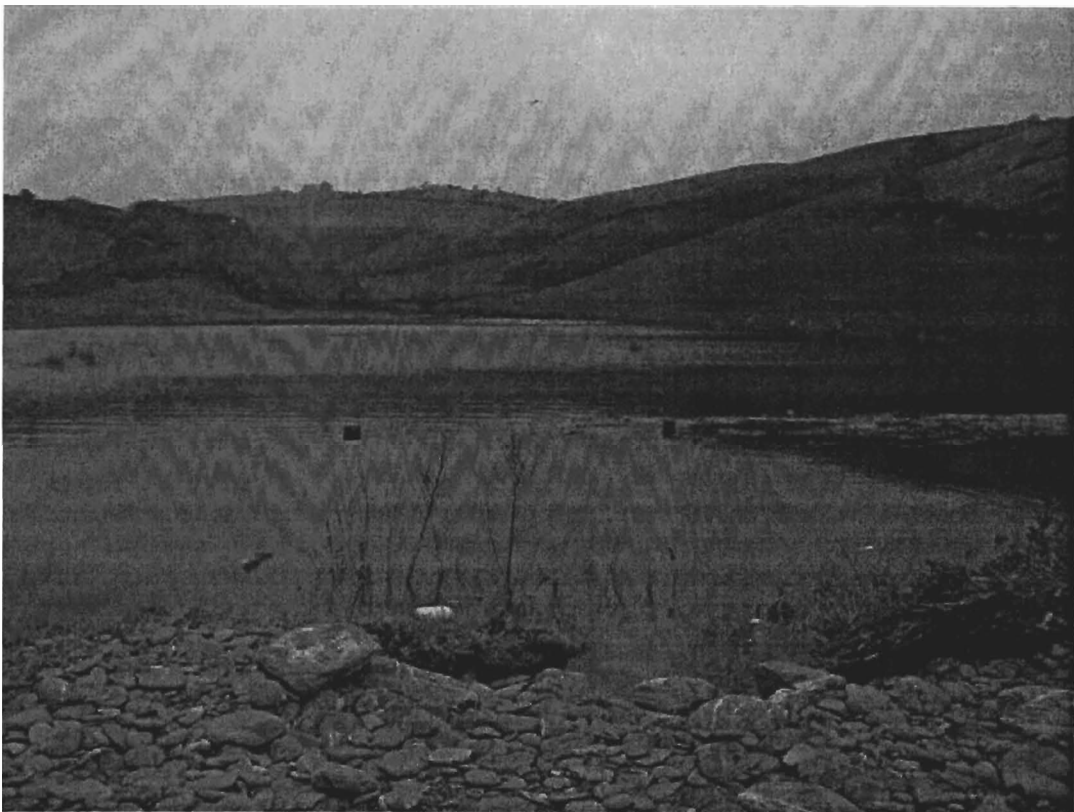





**Inland lake**



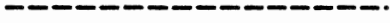

# DARTMOOR NATIONAL PARK PUBLIC PATH DIVERSION ORDER FOOTPATH 32, BRIDFORD

Route to be extinguished (263m) A-B-C   
Route to be created (212m) A-D-E-F   
Paths NOT affected   
Unclassified County Road C-F 

File No. 15/5/4

Scale  
1:2500



© Crown copyright. All rights reserved.  
Dartmoor National Park Authority Licence No 100024842 2007.

Date 16/6/06

Grid Ref. SX7987

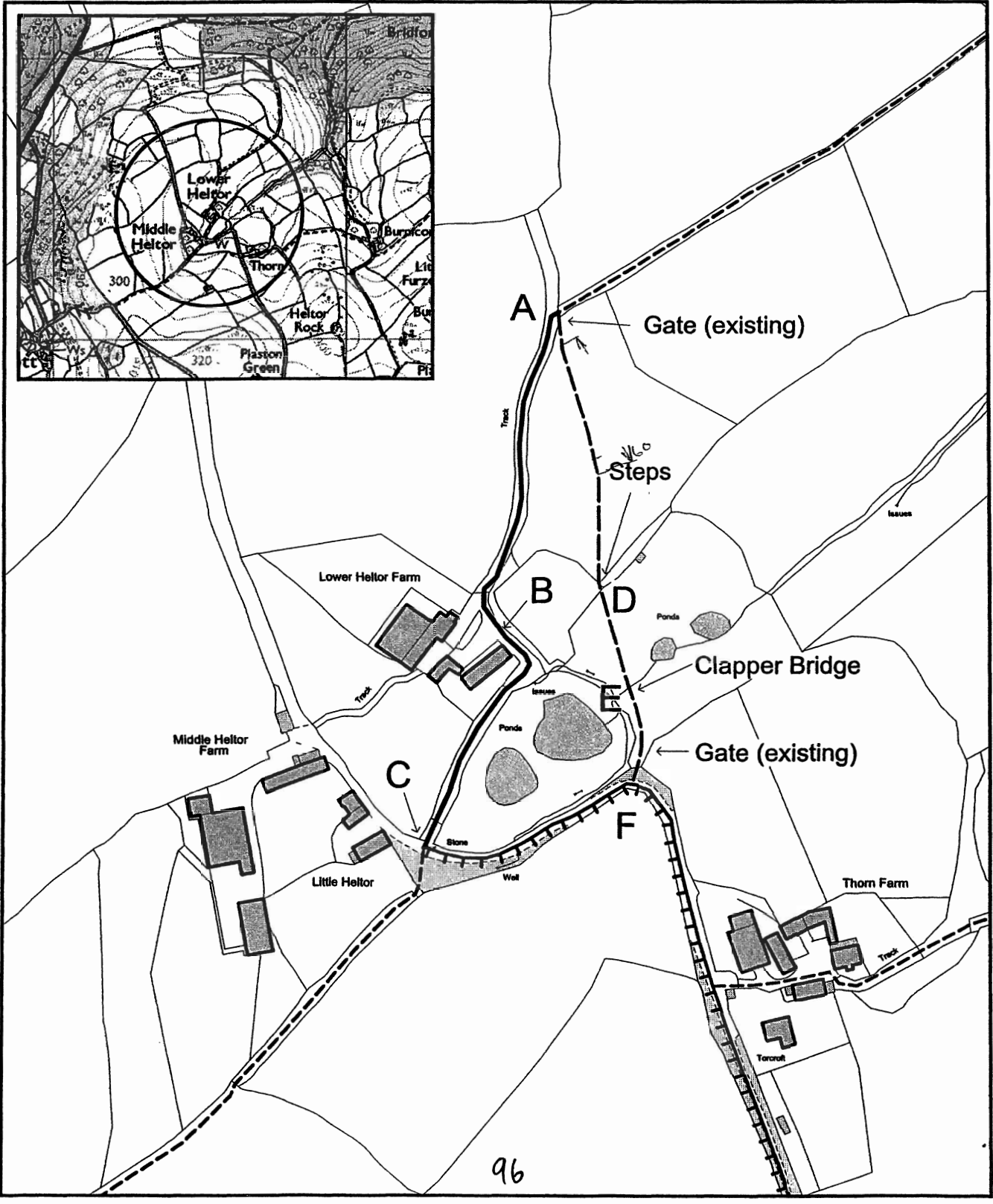
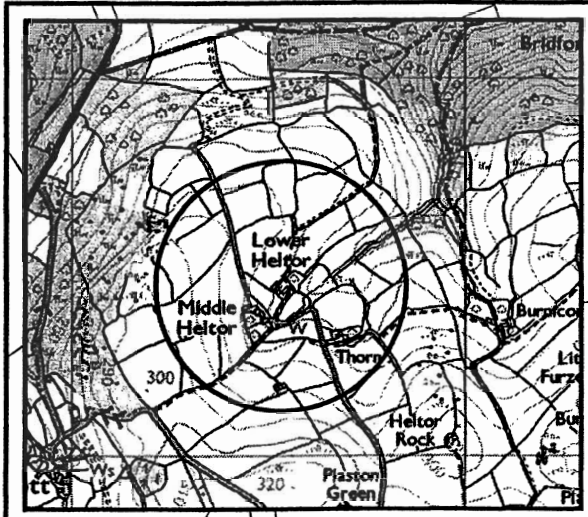

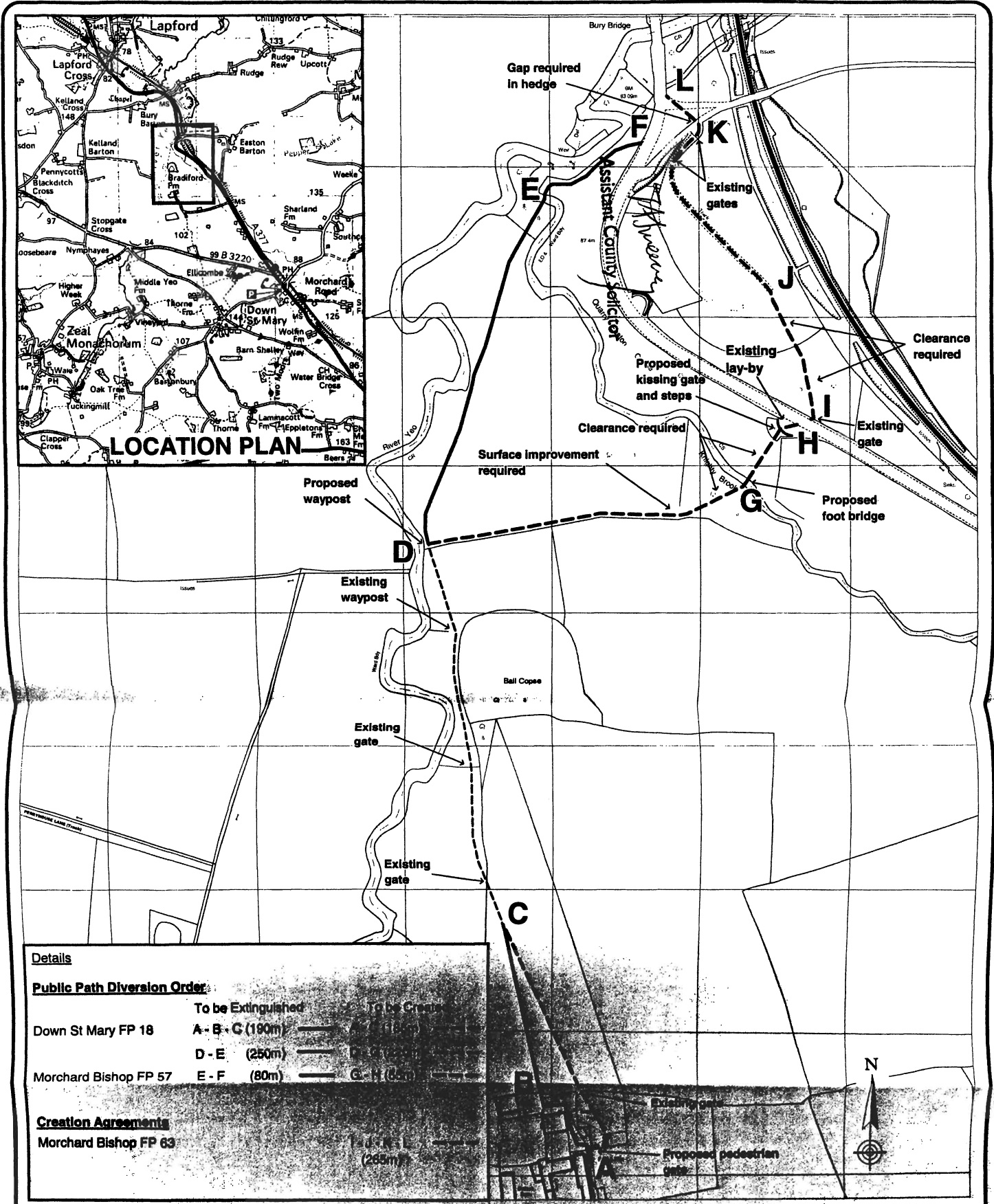

**Details**

**Public Path Diversion Order**

	To be Extinguished	To be Created
Down St Mary FP 18	A - B - G (190m)	A - B - G (190m)
	D - E (250m)	D - E (250m)
Morchard Bishop FP 57	E - F (80m)	G - H (65m)

**Creation Agreements**

Morchard Bishop FP 63	A - B - C (265m)
-----------------------	------------------

map ref SS 7306

Based on Ordnance Survey mapping with the permission of the Controller of Her Majesty's Stationery Office © Crown copyright. Unauthorised reproduction infringes Crown copyright and may lead to prosecution or civil proceedings. Licence No. 100018763

**DEVON COUNTY COUNCIL**

**FOOTPATH NO. 18, DOWN ST MARY & FOOTPATH NO. 57, MORCHARD BISHOP PUBLIC PATH DIVERSION ORDER 2006**

**FOOTPATH NO. 63, MORCHARD BISHOP PUBLIC PATH CREATION AGREEMENTS 2006**

drawing number **ED/PROW/06/109A**

date **August 2006**

scale **1 : 2500 (at A3 only)**

drawn by **PJC for SJ**

**Notation**

To be extinguished	—————
To be created	- - - - -

97

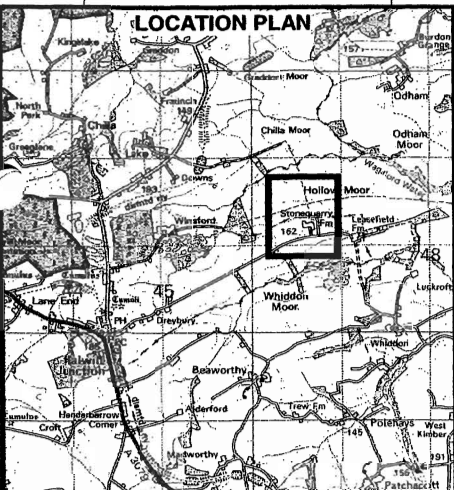
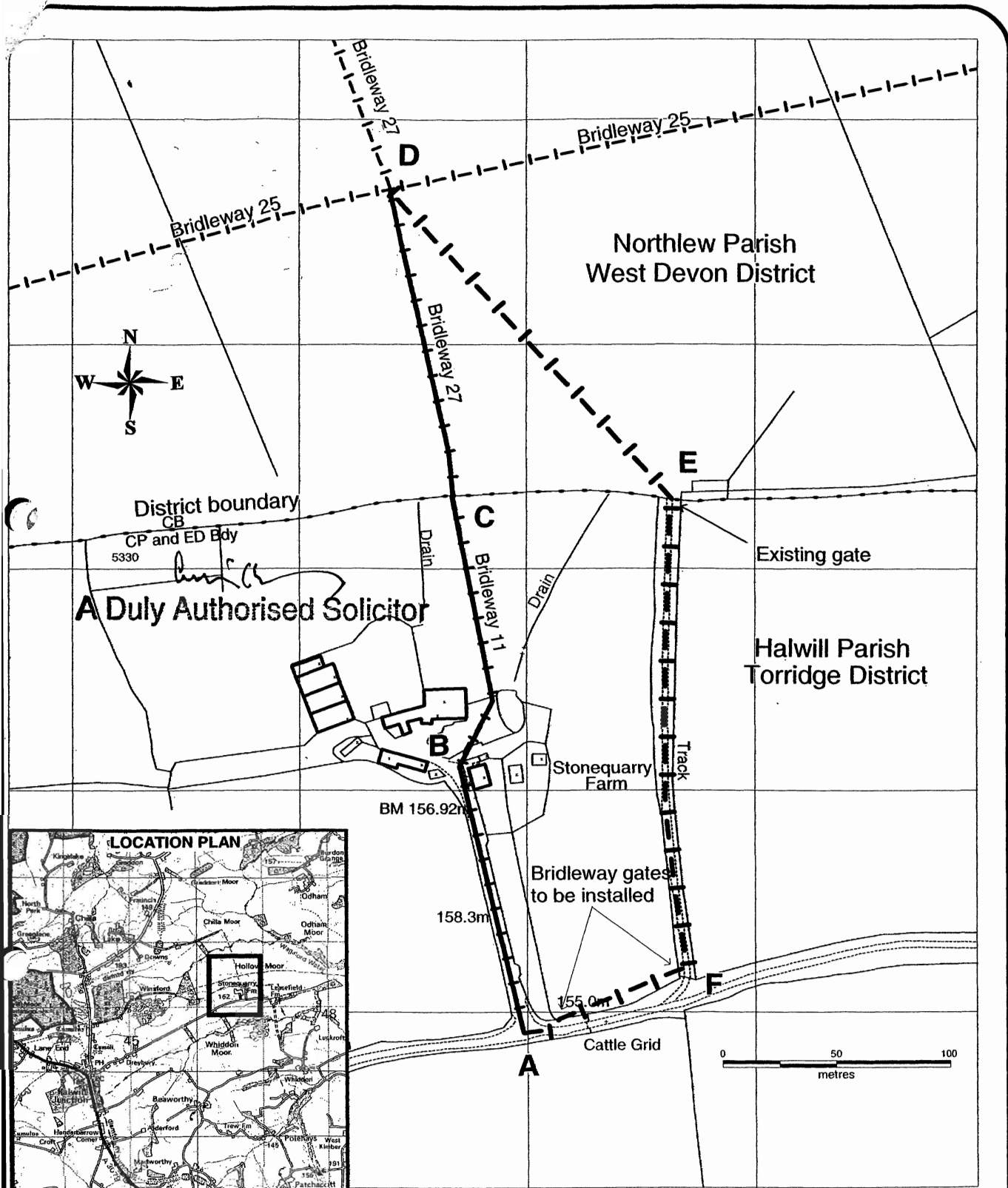

map ref SS 4601

Reproduced from the Ordnance Survey mapping with the permission of the Controller of HMSO. (c) Crown Copyright. Unauthorised reproduction infringes crown copyright and may lead to prosecution or civil proceedings. OS Licence No. 100019783 2006

**DEVON COUNTY COUNCIL  
BRIDLEWAY No. 27 NORTHLEW  
& BRIDLEWAY No. 11 HALWILL  
DIVERSION ORDER 2006**

drawing number ED/PROW/06/24  
 date Feb 06  
 scale 1:2500 (at A4 only)  
 drawn by TF/PY/PJC

Notation	To be extinguished	To be created
Halwill BR No.11	A - B - C (250 metres approx)	A - F - E (290 metres approx)
Northlew BR No.27	C - D (140 metres approx)	E - D (185 metres approx)

**Edward Chorlton**  
 COUNTY ENVIRONMENT DIRECTOR

✓

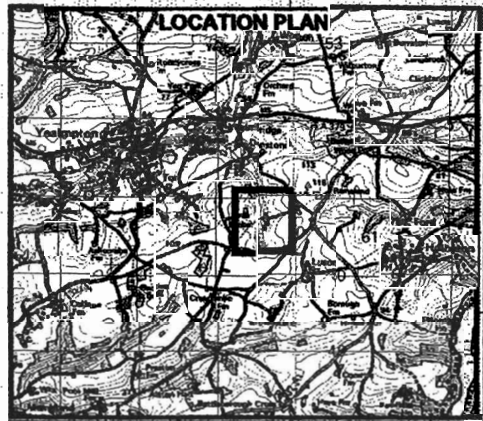
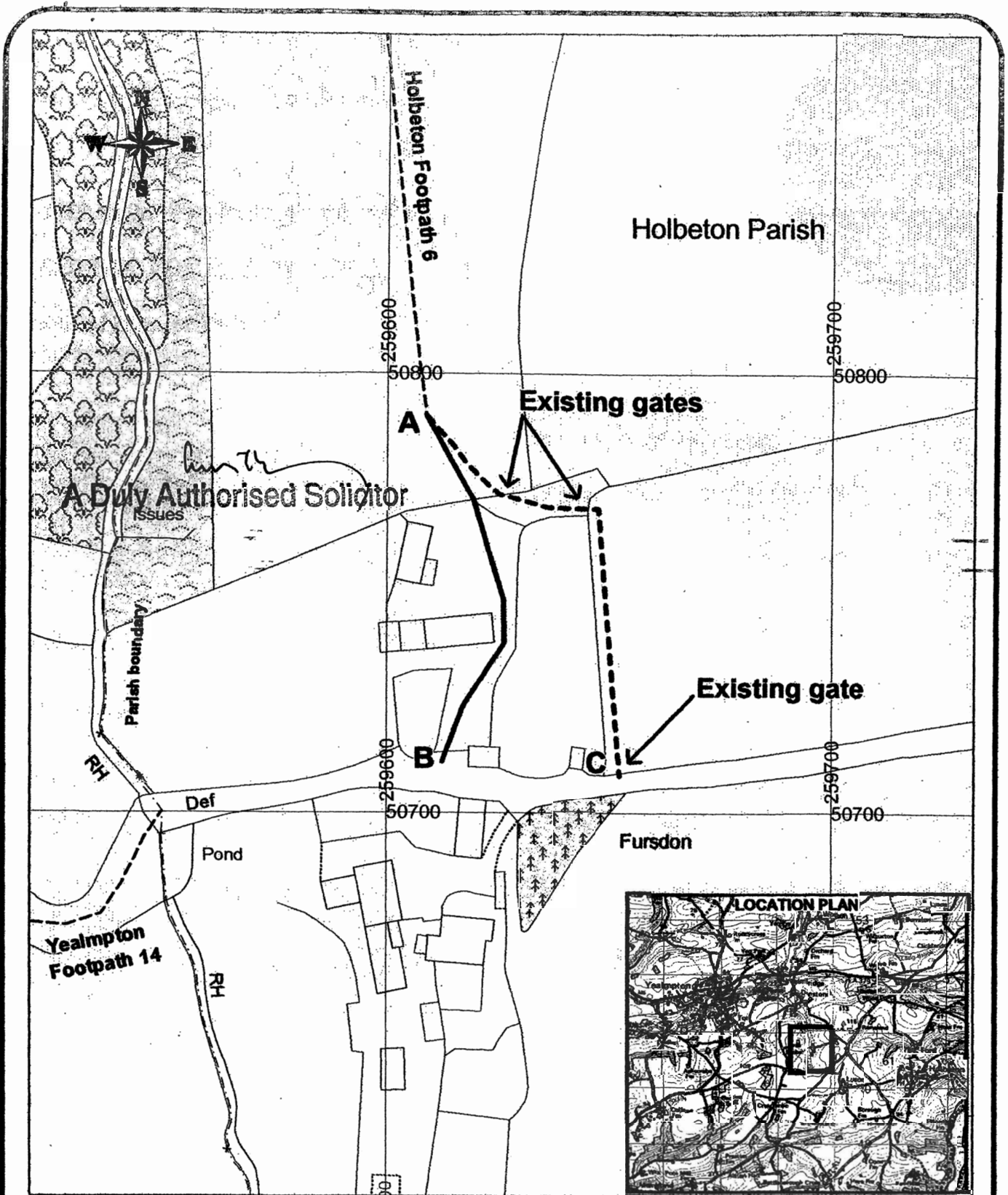

map ref **SX5950**

Reproduced from the Ordnance Survey mapping with the permission of the Controller of HMSO. (c) Crown Copyright. Unauthorised reproduction infringes crown copyright and may lead to prosecution or civil proceedings. OS Licence No. 100018783

**DEVON COUNTY COUNCIL  
FOOTPATH No. 6, HOLBETON  
PUBLIC PATH DIVERSION ORDER 2007**

drawing number **ED/PROW/06/153**  
 date **Nov 06**  
 scale **1:1250 (at A4 only)**  
 drawn by **PGY/PG**

<u>Notation</u>	To be extinguished	To be created
Footpath 6	A - B 85 metres approx)	A - C (105 metres approx)

**Edward Chorlton**  
COUNTY ENVIRONMENT DIRECTOR





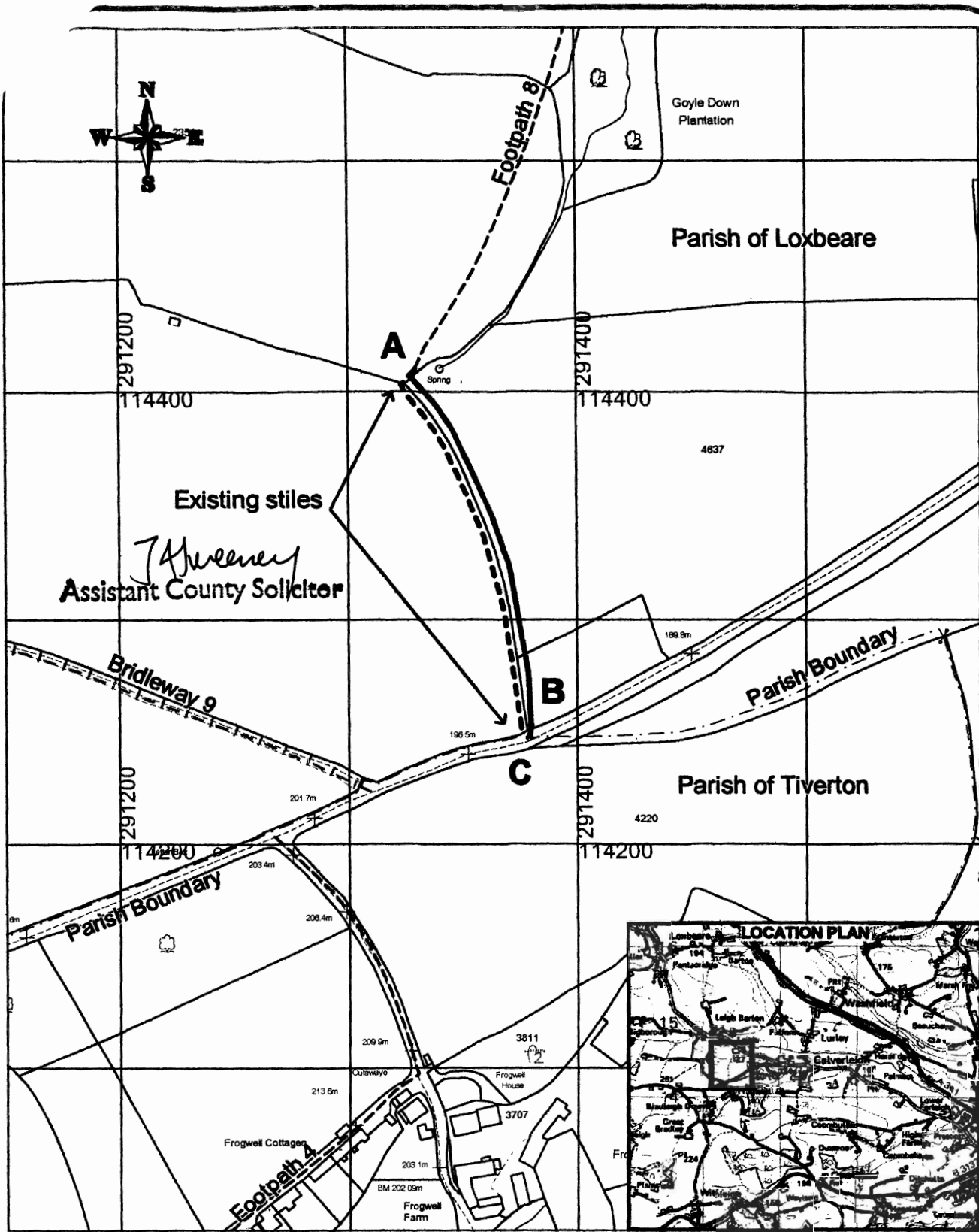

map ref **SS9114**

Reproduced from the Ordnance Survey mapping with the permission of the Controller of HMSO. (c) Crown Copyright. Unauthorised reproduction infringes crown copyright and may lead to prosecution or civil proceedings. OS Licence No. 100016783

**DEVON COUNTY COUNCIL  
FOOTPATH NO. 8, LOXBEARE  
PUBLIC PATH DIVERSION ORDER 2007**

drawing number **ED/PROW/06/174**  
 date **Nov 06**  
 scale **1:2500 (at A4 only)**  
 drawn by **PGY/IP**

<u>Notation</u>	To be extinguished	To be created
Footpath 2	A - B (175 metres approx)	A - C (175 metres approx)

**Devon** County Council   
**Edward Chorlton**  
 DIRECTOR OF ENVIRONMENT, ECONOMY & CULTURE

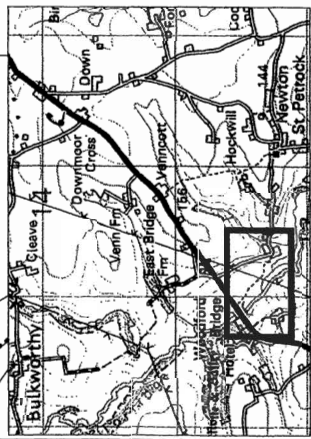
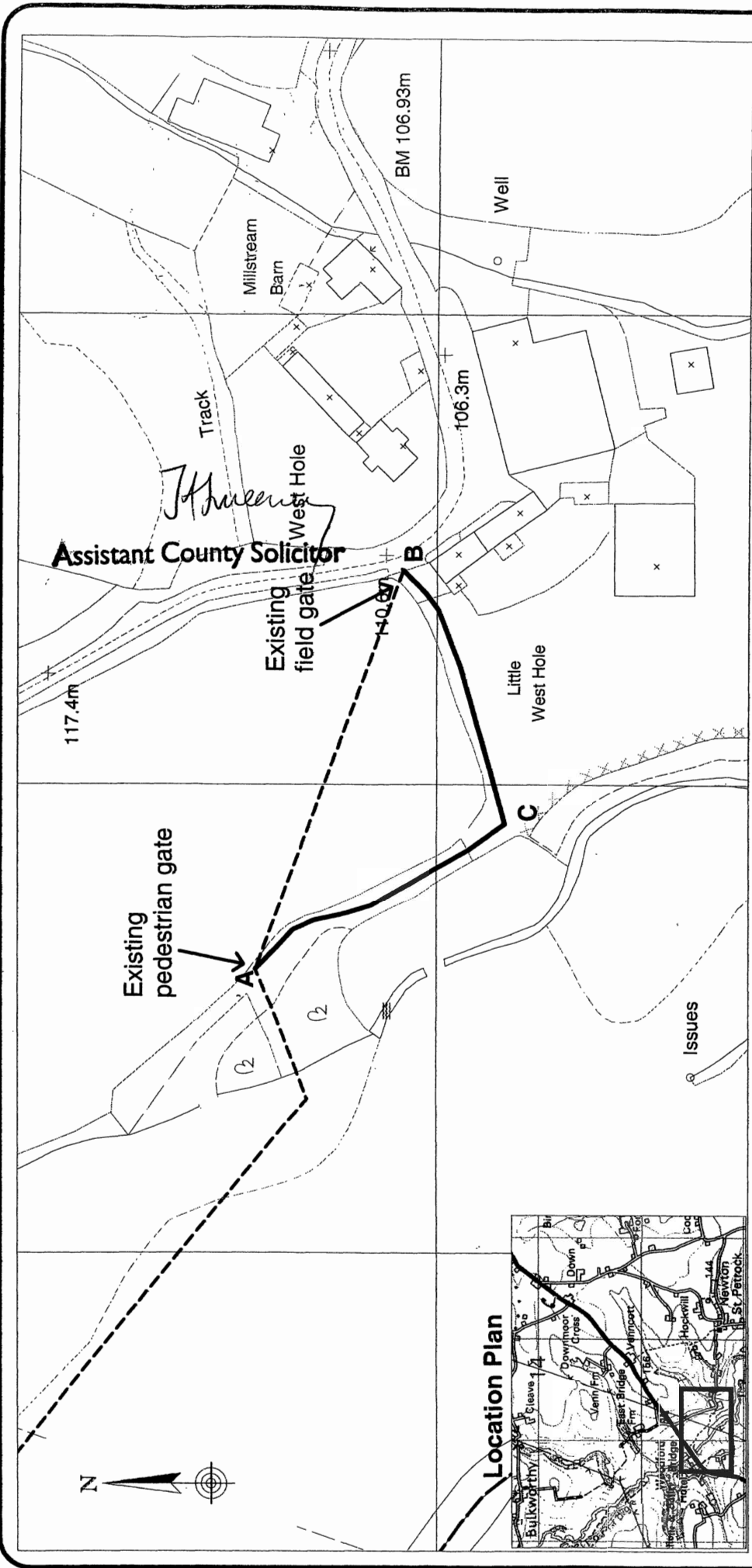

map ref: **SS4012**

Reproduced from Ordnance Survey mapping with the permission of the Controller of Her Majesty's Stationary Office © Crown copyright  
 Unauthorised reproduction infringes Crown copyright and may lead to prosecution or civil proceedings. OS Licence No. 100019783

**DEVON COUNTY COUNCIL  
 PUBLIC PATH DIVERSION ORDER 2007  
 FOOTPATH NO. 1 NEWTON ST PETROCK**

drawing number **ED/PROW/06/128**  
 date **7 Sept 2006**  
 scale **1:1250**  
 drawn by **BM for JR**

To be extinguished **———** (approx 120 m)  
 To be created **-----** (approx 90 m)

Notation

**Edward Chorlton**  
 COUNTY ENVIRONMENT, ECONOMY  
 AND CULTURE DIRECTOR



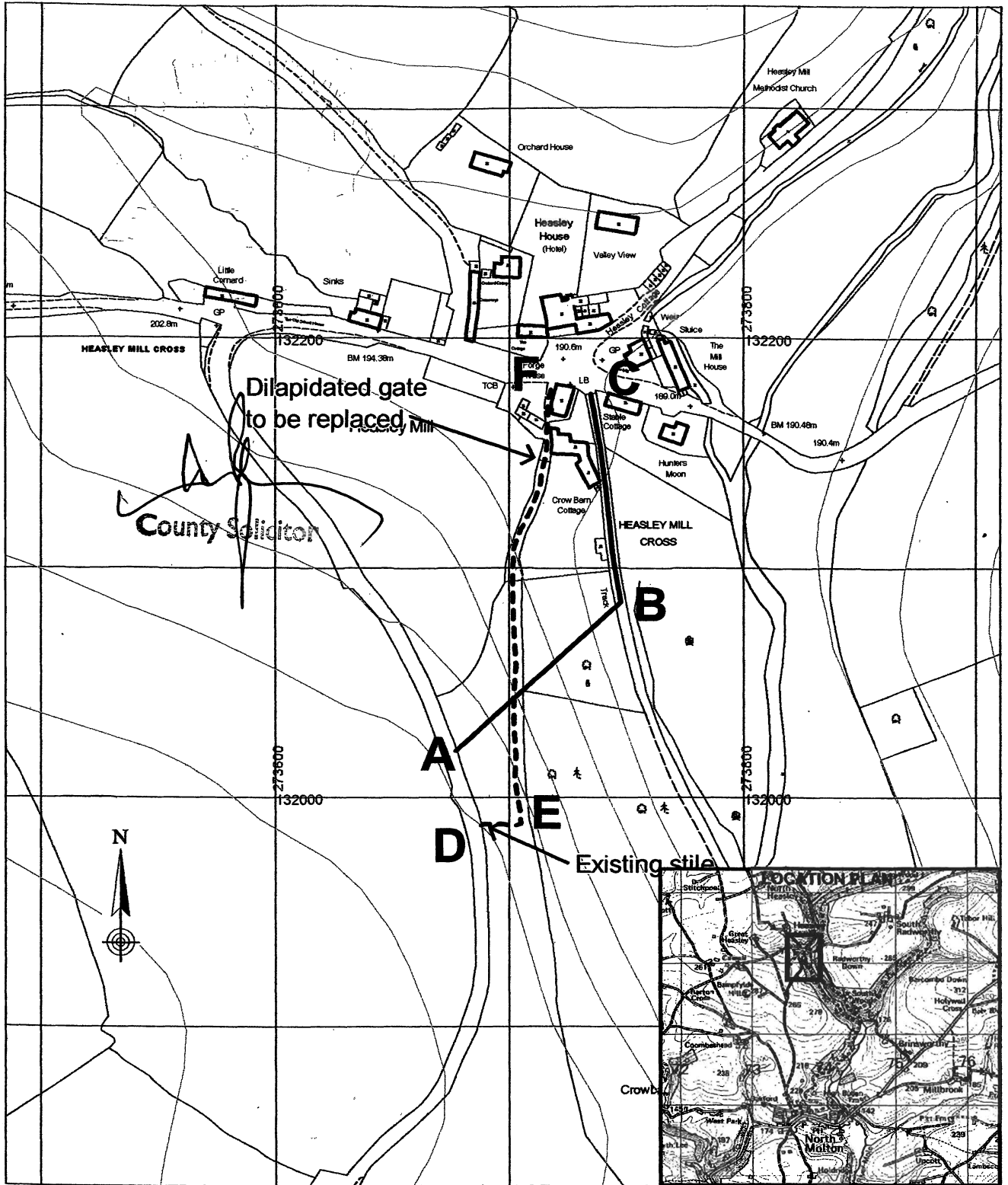

map ref **SS 7332**

Reproduced from Ordnance Survey mapping with the permission of the Controller of Her Majesty's Stationery Office © Crown copyright  
 Unauthorised reproduction infringes Crown copyright and may lead to prosecution or civil proceedings. Licence No. LA076562

**DEVON COUNTY COUNCIL**  
**FOOTPATH No. 6, NORTH MOLTON**  
**PUBLIC PATH DIVERSION ORDER 2006**

drawing number **ED/PROW/05/133A**  
 date **January 2006**  
 scale **1:2500**  
 drawn by **IP/PGY/PJC**

Notation	To be extinguished	To be created
Footpath No. 6	A - B - C (190 metres approx)	D - E - F (210 metres approx)

**Edward Chorlton**  
 COUNTY ENVIRONMENT DIRECTOR



DEVON COUNTY COUNCIL

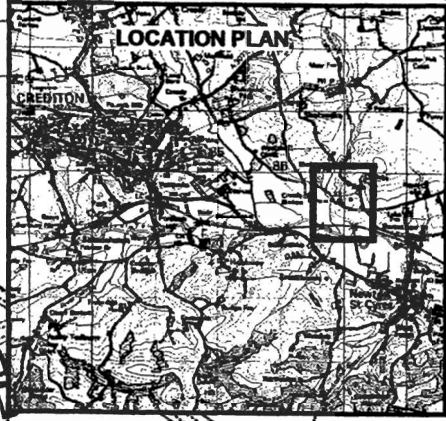

*County Solicitor*

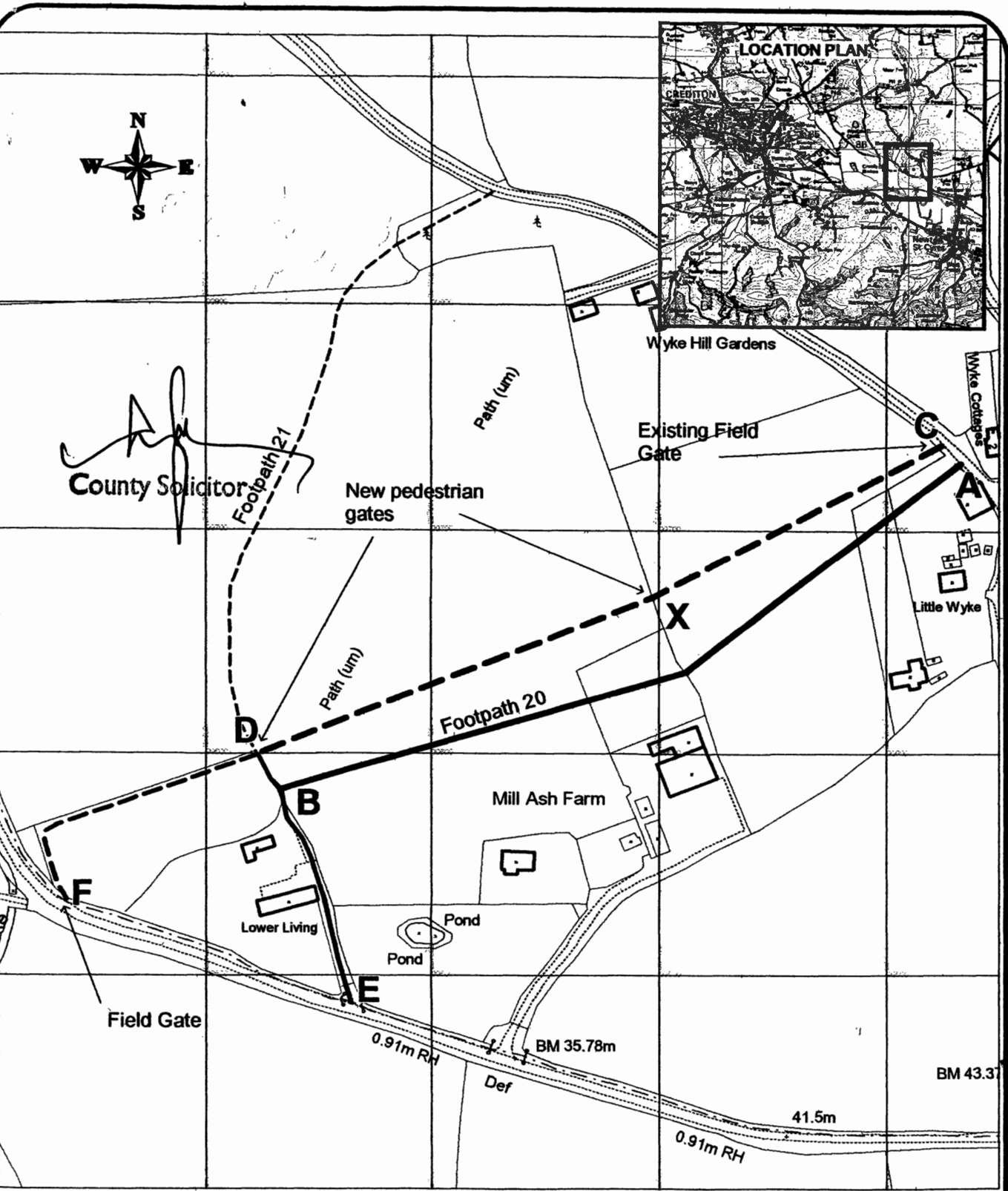

map ref **SX 8699 & 8799**

Reproduced from the Ordnance Survey mapping with the permission of the Controller of HMSO. (c) Crown Copyright. Unauthorised reproduction infringes crown copyright and may lead to prosecution or civil proceedings. OS Licence No. 100019783

**DEVON COUNTY COUNCIL**  
**FOOTPATH Nos. 20 & 21, SHOBROOKE**  
**PUBLIC PATH DIVERSION ORDER 2006**

drawing number **ED/PROW/06/05a**  
 date **March 06**  
 scale **1:2500 (at A4 only)**  
 drawn by **PGY/AS**

Notation	To be extinguished	To be created
Footpath 20	A - B (340 metres approx)	C - D (330 metres approx)
Footpath 21	E - B - D (120 metres approx)	D - F (130 metres approx)

**Edward Chorlton**  
 COUNTY ENVIRONMENT DIRECTOR



DEVON COUNTY COUNCIL

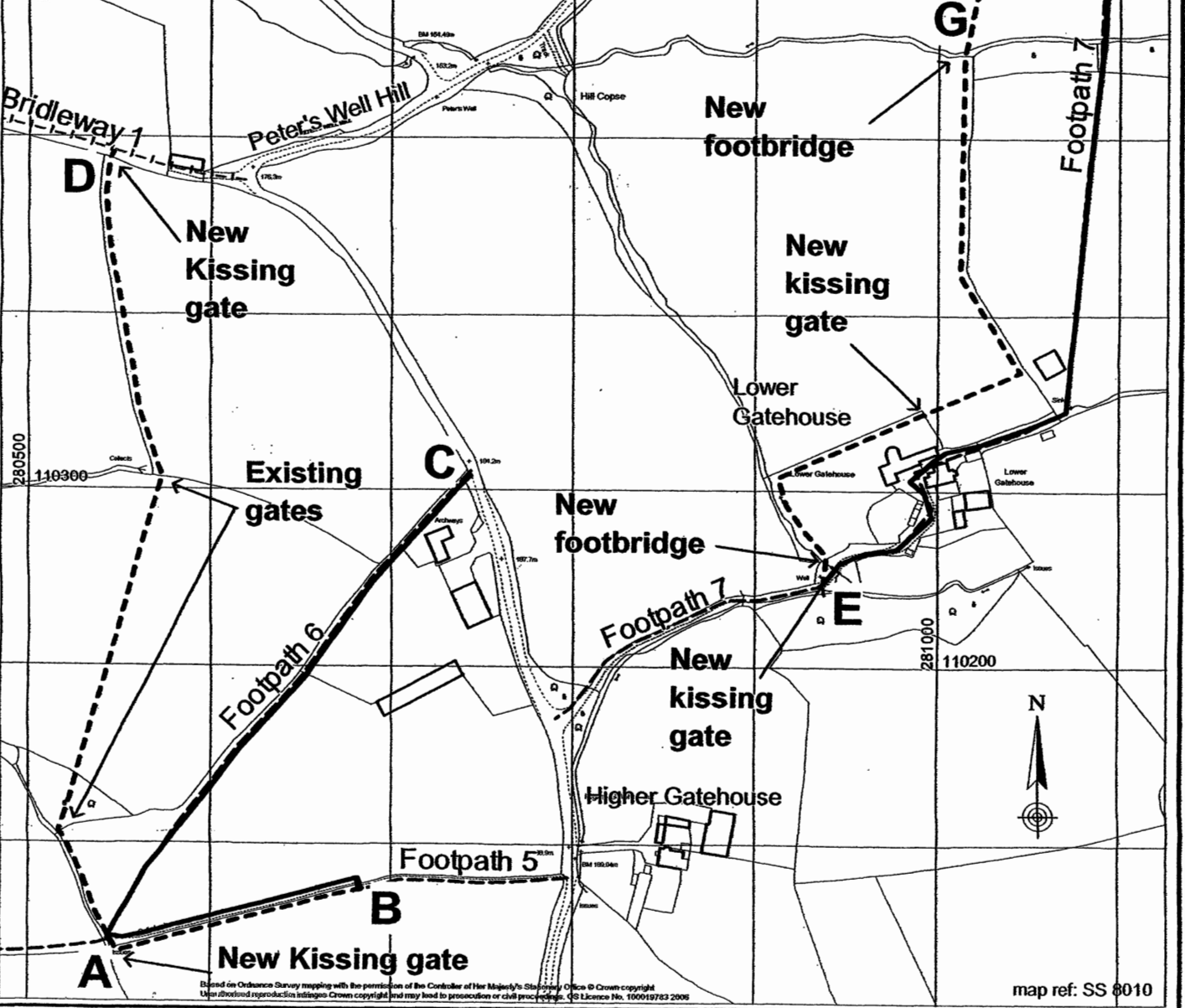
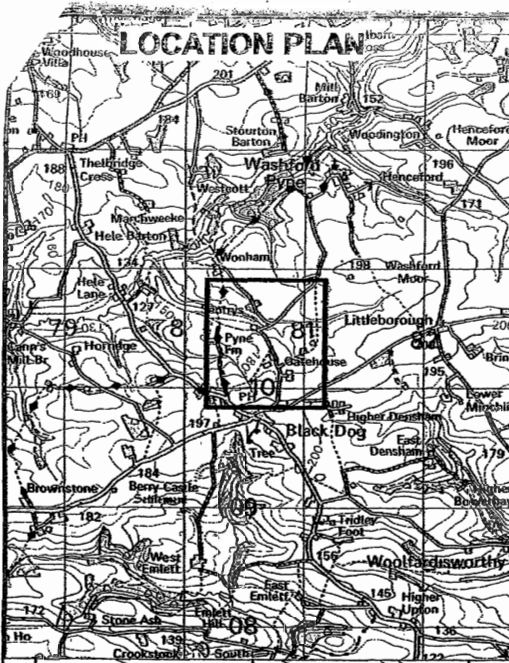

Based on Ordnance Survey mapping with the permission of the Controller of Her Majesty's Stationery Office © Crown copyright. Use of this reproduction infringes Crown copyright and may lead to prosecution or civil proceedings. OS Licence No. 100019783 2006

map ref: SS 8010

**DEVON COUNTY COUNCIL  
DIVERSION ORDER 2006  
FOOTPATH Nos. 5, 6 & 7, WASHFORD PYNE**

104

drawing number **ED / PROW / 06 / 53**  
date **April 2006**  
scale **1 : 2500 (at A3 only)**  
drawn by **PGY / RS**

Notation	To be extinguished	To be created
Footpath 5	A - B (150 metres approx)	A - B (150 metres approx)
Footpath 6	A - C (330 metres approx)	A - D (460 metres approx)
Footpath 7	E - F (715 metres approx)	E - G - F (710 metres approx)

**Edward Chorlton**  
COUNTY ENVIRONMENT DIRECTOR